

Getting Started

Attach the shoulder strap to the carrying case.

Before using the SimplyGo device for the first time, the SimplyGo battery requires an initial uninterrupted charging time of 4 hours minimum. This can be accomplished by installing the battery and using the AC Power Cord, as described in the following pages.

Note: Philips Respironics does not recommend using DC power for this initial charging.

Caution: Use only Philips Respironics batteries in your SimplyGo device. Using other batteries could damage the device and will void the warranty. Remove the battery if the SimplyGo will not be used for an extended period of time.

Battery Duration Times

SimplyGo's battery times vary depending on which operating mode (Pulse or Continuous Flow) is being used and which setting is selected in the operating mode. SimplyGo is designed to allow easy access to the battery so that it is easy to swap out and utilize extra batteries (sold separately) as needed. Extra batteries fit easily into the zippered pouch of the carrying case or in the handy accessories bag. Additionally, extra batteries can be charged in the external battery charger (sold separately) or in the SimplyGo device (see the "Charging the Battery with the AC Power Supply" section), allowing maximum flexibility to meet your specific battery needs.

The following shows the approximate battery durations for Pulse flow settings at 20 BPM and Continuous Flow settings when the battery is fully charged. Your times may vary based on your activity level, the condition of the batteries, and the age of your SimplyGo device.

PULSE DOSE SETTING						CONTINUOUS FLOW SETTING		
1	2	3	4	5	6	0.5	1	2
3.4 hours	3.0 hours	2.2 hours	1.7 hours	1.3 hours	1.3 hours	2.9 hours	1.6 hours	0.9 hours

System Overview

Begin by becoming familiar with your SimplyGo device.

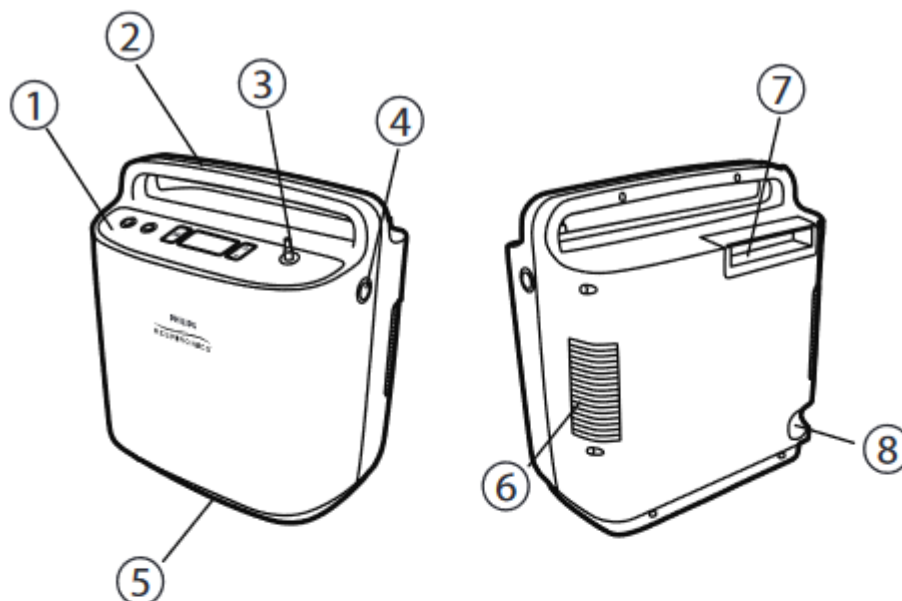

Item	Description	Function
1	Control Panel	Control switches and LCD display
2	Carrying Handle	Hand grip area for lifting and transporting the device
3	Patient Cannula Connector	Oxygen output and connection point for patient cannula
4	Power Input Connector	Connection point for Philips Respironics-provided external power supplies: AC line voltage, vehicle DC
5	Air Exhaust Vent	Air outlet for enclosure ventilation fan
6	Air Intake Vent	Air inlet for enclosure ventilation fan
7	Battery	Rechargeable lithium-ion battery with integrated handle used to remove and install battery pack
8	Data Port	Input-Output data communication with the device. Caution: For use by authorized service personnel only.

Control Panel

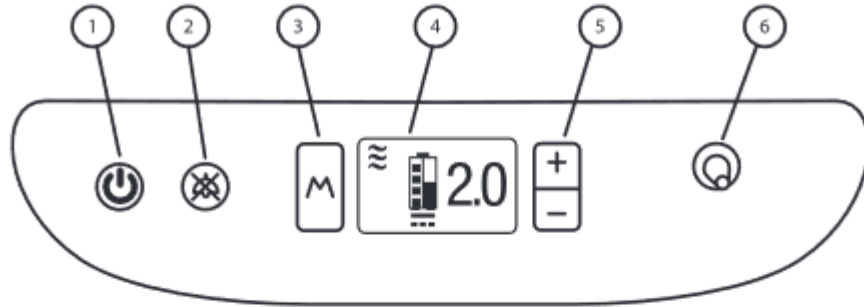

Item	Description	Function
1	Power	Turns the device On and Off
2	Alarm Silence	Turns the audible alarm off
3	Mode	Selects one of the three possible operating states of the device
4	Display Screen	Shows information about the operating status of the device
5	Plus (+)/Minus (-)	+ Increases the displayed setting; - Decreases the displayed setting
6	Patient Cannula Connector	Oxygen output and connection point for patient cannula

Run Time Screen Description

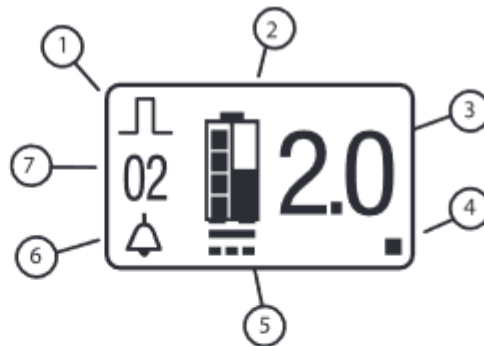

Item	Symbol Description	Function
1	Operating Mode	For detailed descriptions, refer to the "Alarm Indicator and Screen Symbols" section.
2	Battery Status	
3	Setting	
4	Breath Indicator	
5	External Power Status	
6	Audible Alarm Status	
7	Alarm Type	

Inserting and Removing the Batteries

Your SimplyGo device comes with one rechargeable lithium ion battery. To insert it correctly, follow these steps.

1. Place your device in a well ventilated location and make sure it is turned off.

Note: The SimplyGo device is shipped from the factory with the battery removed.

Caution: Only remove the battery when the SimplyGo is turned off. Never remove the battery while the device is operating.

2. To remove the battery, insert your fingers into the opening in the battery handle. Steadily pull upward on the handle until the battery is released from the enclosure. Continue to lift the battery until it is entirely removed from the battery compartment. If the device has been operating, the surfaces may be warm to the touch. This is normal.



3. Check the battery gauge (shown below). To do so, press the white button (shown below) on the battery and watch how many LEDs light up. If the batteries are low, you can recharge them. See the Charging the Battery with AC Power Supply section.

No. of LEDs	Battery Charge
4 LEDs Light:	75% to 100% full
3 LEDs Light:	50% to 75% full
2 LEDs Light:	25% to 50% full
1 LED Lights:	10% to 25% full
1 LED Blinks 3 Times:	Battery is less than 10% full and needs to be recharged

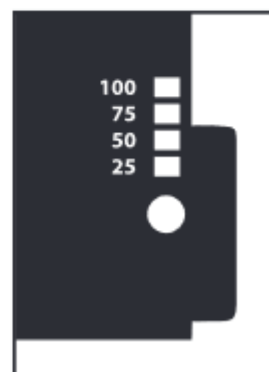

- To insert the battery, insert your fingers into the opening in the battery handle and grip the handle between your fingers and thumb. Position the battery over the battery compartment in the top, rear corner of the SimplyGo enclosure with your fingers pointing toward the handle. The battery compartment is shaped so that there is only one way the battery can be inserted and this will align the battery correctly.

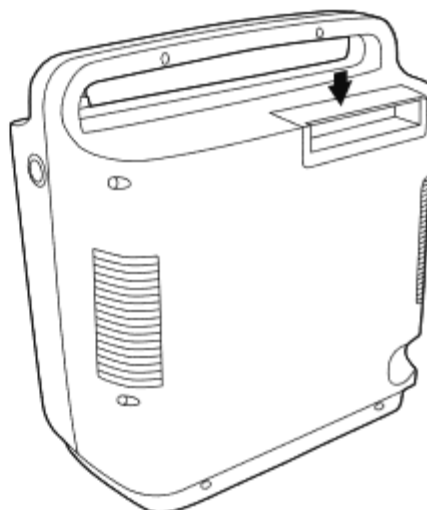

Lower the battery into its compartment until the handle contacts the equipment enclosure. Firmly push on the battery handle until it snaps into place in the enclosure top.

- After the battery is inserted, check to make sure the battery handle is level with or slightly below the top of the plastic case.

- Momentarily depress the Power key, and the following should occur:

- The LCD and the 5 Key backlights turn ON
- The screen shown here displays on the LCD

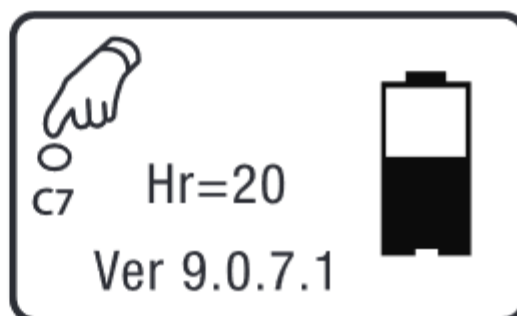

If you do not see the battery symbol or the device does not turn On, the battery is not installed correctly. Re-insert the battery and make sure it snaps in place.

Charging the Battery with the AC Power Supply

Important: The first time you charge the battery, be sure to charge it fully. Do not use the DC power cord to do so; instead use AC power.

Note: The battery will begin charging whenever you connect the device to an AC outlet, even if you're using it.

To charge the battery using the AC Power Cord provided with your system, follow these steps.

1. Connect the AC Power Supply's output cable to the SimplyGo power input connector.
2. Connect the AC Power Cord's connector into the AC power supply.
3. Connect the AC Power Cord's plug into an AC outlet installed to meet national or regional electrical code.

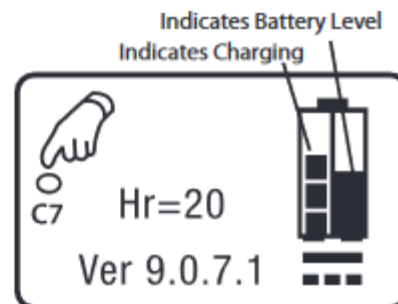

Note: As soon as you connect the device to an energized AC power source, the light on the AC Power Supply lights up. The cooling fan will turn on when the battery begins to charge. This is normal. The fan will run the entire time it is charging to keep the battery cool.

4. When charging is complete (this takes four hours or less), disconnect the AC Power Supply and store it with the AC Power Cord for future use.

Note: Replacement and spare batteries are available separately. For information, contact your home care provider.

Note: An optional SimplyGo Smart Battery Charger/Recalibrator (sold separately) is available for your system. For more information, contact your home care provider.

Operating the SimplyGo Device

Power Options

Warning: Do not use the device without the battery installed and operating.

- To run the device on battery power, make sure the battery is properly inserted and sufficiently charged. (The battery should be fully charged the first time you use it.)
- **To run the device using AC power**, first make sure you have a battery installed. Then, follow these steps:
 1. Connect the output cable of the AC Power Supply to the SimplyGo power input connector.
 2. Connect the AC Power Cord's connector into the AC power supply.
 3. Connect the AC Power Cord's plug into an AC outlet installed to meet national or regional electrical code.

Note: The AC Power Supply is equipped with a green light, which illuminates when it is connected to an energized AC power source.

- **To run the device using DC power** from an automobile or other motorized vehicle, make sure the battery is installed. Start the vehicle and connect one end of the DC Power Cord to the device's power inlet and the other end into the vehicle's DC electrical outlet.

Because the amount of current available in the vehicle electrical system is limited, the current available to charge the SimplyGo battery will be determined by the operating mode of the device. At high settings the time required to charge the battery will be much longer and at the highest settings, it may not charge at all.

Device Warm-Up

When you turn on your SimplyGo device, it will sense if you are breathing from it. If you are not yet breathing through the cannula, SimplyGo will begin to pulse automatically about once every five seconds. As soon as you begin breathing through the cannula, the device will begin delivering pulses based on your breathing. It may take up to 20 minutes for the SimplyGo output to stabilize within its O₂ purity specifications. However, you may begin breathing from the SimplyGo at any time.